

90 DEGREE ADAPTORS

C-NP-90

FEMALE BSPP X UNO POSITIONAL 90°
 BSPP FEMALE SWIVEL W. 60° CONE X UNO POSITIONAL
 MALE 90° FORGING

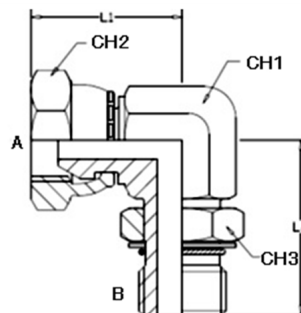

Part Number	BSPP Female Thread (A)	UNO Male Thread (B)	L1 - mm	L2 - mm	Hex A/F (CH1)	Hex A/F (CH2)	Hex A/F (CH3)
C-NP-90-0409	1/4-19	9/16-18	26.2	27.2	11	19	17
C-NP-90-0609	3/8-19	9/16-18	30.1	33.3	16	19	22
C-NP-90-0612	3/8-19	3/4-16	30.1	36.8	19	24	22
C-NP-90-0812	1/2-14	3/4-16	36.4	36.8	19	24	27
C-NP-90-0814	1/2-14	7/8-14	36.4	44	22	27	27
C-NP-90-1214	3/4-14	7/8-14	43.5	48.9	27	27	32
C-NP-90-1217	3/4-14	1.1/16-12	43.5	51	27	32	32
C-NP-90-1621	3/4-14	1.5/16-12	50.5	54.5	33	41	41

† - Please contact Hydraulink for further details and availability.

Pricing current as at 14 Feb 2017 and excludes GST. Hydraulink reserve the right to change pricing and technical specifications without notice.