

Buttweld Equal Tee (Std)

Buttweld STD ASTM A234 WPB ANSI B16.9 Equal Tee						
AAP CODE	IMPERIAL SIZE	A	B	C	WALL THICKNESS	APPROX. KG/PC
WT15	1/2	22.0	15.7	25	2.9	0.1
WT20	3/4	26.7	20.9	28.4	2.9	0.16
WT25	1	33.4	26.6	38.1	3.4	0.36
WT32	1 1/4	42.2	35.0	47.8	3.6	0.5
WT40	1 1/2	48.3	40.9	57.2	3.7	0.7
WT50	2	60.3	52.5	63.5	3.9	1.0
WT65	2 1/2	73.0	62.6	76.2	5.2	1.8
WT80	3	88.9	77.9	85.9	5.5	2.7
WT94	4	114.3	102.3	104.6	6.1	4.4
WT95	5	141.3	128.1	124.0	6.6	7.0
WT96	6	168.3	154.1	142.7	7.1	10.0
WT98	8	219.1	202.7	177.8	8.2	19.0
WTX25	10	273.1	254.5	215.9	9.3	30.0
WTX30	12	323.9	304.9	254.0	9.5	47.0
WTX35	14	355.6	336.5	279.0	9.5	60.0
WTX40	16	406.4	387.3	305.0	9.5	75.0
WTX45	18	457.0	437.9	343.0	9.5	96.0
WTX50	20	508	488.9	381	9.5	
WTX60	24	610.0	590.9	432.0	9.5	139.0

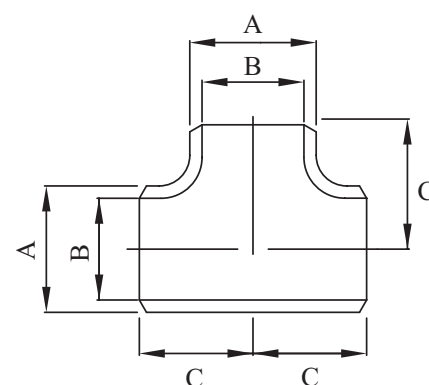

Buttweld Reducing Tee (Std)

Buttweld STD ASTM A234 WPB ANSI B16.9 Reducing Tee									
AAP CODE	IMPERIAL SIZE	LARGER DIAMETER		SMALLER DIAMETER		CENTRE TO END		WALL THICKNESS	APPROX. KG/PC
		A1	A2	B1	B2	C1	C2		
WT5025	2 x 1	60.3	52.5	33.4	26.6	63.5	63.5	3.9	1.1
WT5040	2 x 1 1/2	60.3	52.5	48.3	40.9	63.5	63.5	3.9	1.0
WT6550	2 1/2 x 2	73.0	62.6	60.3	52.5	76.2	69.8	5.2	1.9
WT8050	3 x 2	88.9	77.9	60.3	52.5	85.9	82.6	5.5	2.4
WT8065	3 x 2 1/2	88.9	77.9	73.0	62.6	85.9	82.6	5.5	2.4
WT9480	4 x 3	114.3	102.3	88.9	77.9	104.6	98.6	6.1	4.0
WT9694	6 x 4	168.3	154.1	114.3	102.3	142.7	130.0	7.1	9.5
WT9896	8 x 6	219.1	202.7	168.3	154.1	177.8	168.1	8.2	18.0

