

STANDARD SIZE

NPS mm	O.D. mm	“A” mm	Weight (kilos)
50*	60	90	0.6
80	89	110	2.3
100*	114	140	3.5
150*	165	170	7.5
200*	219	195	14.8

EQUAL TEE

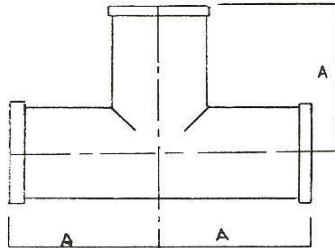

LONG SIZE

NPS mm	O.D. mm	“A” mm	Weight (kilos)
50	60	152	2.5
80	89	203	5.4
100	114	229	8.5
150	165	254	15.0
200	219	305	30.0

*AVAILABLE AS CAST FITTINGS

ALL MEASUREMENTS AND WEIGHTS ARE APPROXIMATE

STANDARD SIZE

NPS mm	O.D. mm	“A” mm	Weight (kilos)
50	60	80	1.4
80	89	105	2.0
100	114	127	4.9
150	165	127	7.4
200	219	155	12.0

FLANGED ADAPTORS

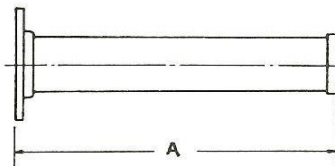

LONG SIZE

NPS mm	O.D. mm	“A” mm	Weight (kilos)
50	60	318	3.2
80	89	423	7.8
100	114	470	8.7
150	165	507	16.0
200	219	605	28.0

ALL MEASUREMENTS AND WEIGHTS ARE APPROXIMATE