

Saddle Single Outlet with Reinforcing Ring and SS B&N

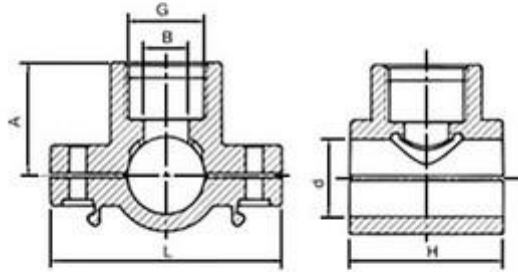

Plasson Australia Code	d [mm]	L [mm]	A [mm]	H [mm]	B	Rp [mm]	Weight [g]
1607055	20					1/2"	62
1607056	25					1/2"	70
1607057	25					3/4"	72
1607058	32					1/2"	133
1607059	32					3/4"	134
1607060	32					1"	142
1607061	40					1/2"	140
1607062	40					3/4"	142
1607063	40					1"	150
1607064	50					1/2"	178
1607065	50					3/4"	179
1607066	50					1"	186
1607067	50					1 1/4"	211
1607068	63					1/2"	277
1607069	63					3/4"	279
1607070	63					1"	292
1607071	63					1 1/4"	307
1607072	63					1 1/2"	321
1607073	75					1/2"	279
1607074	75					3/4"	369
1607075	75					1"	375
1607076	75					1 1/4"	397
1607077	75					1 1/2"	409
1607078	75					2"	432

<u>Plasson Australia Code</u>	<u>d [mm]</u>	<u>L [mm]</u>	<u>A [mm]</u>	<u>H [mm]</u>	<u>B</u>	<u>Rp [mm]</u>	<u>Weight [g]</u>
1607079	90					1/2"	460
1607079	90					1/2"	460
1607080	90					3/4"	453
1607081	90					1"	460
1607082	90					1 1/4"	481
1607083	90					1 1/2"	493
1607084	90					2"	510
1607085	110					1/2"	560
1607086	110					3/4"	561
1607087	110					1"	566
1607088	110					1 1/4"	587
1607089	110					1 1/2"	600
1607090	110					2"	615
1607091	125					3/4"	748
1607092	125					1"	754
1607093	125					1 1/4"	777
1607094	125					1 1/2"	781
1607095	125					2"	796
1607098	140					2"	959
1607099	160					1"	1071
1607101	160					1 1/2"	1071
1607102	160					2"	1080
1607103	180					1"	1299
1607104	180					1 1/4"	1319
1607105	180					1 1/2"	1327
1607106	180					2"	1333