

KLAMBON SHOULDERED END SYSTEM

TOGGLE COUPLINGS

These couplings are ideal for very fast coupling and release. Couplings are manufactured from cast steel grade 1030min.

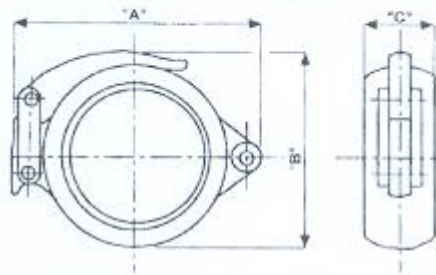

| Pipe Size nb mm | Coupling Dimensions | | | Theoretical mass Kg each |
|--------------------|---------------------|-----|----|-----------------------------|
| | A | B | C | |
| 100 | 220 | 185 | 52 | 2,6 |
| 150 | 275 | 227 | 52 | 3,6 |

Toggle couplings are supplied with a locking clip to prevent accidental opening of the coupling. Couplings are rated to 25 bar working pressure, 50 bar test pressure.