

## SAE FLANGES

### S61

SAE CODE 62 SWEPT 90°  
 90° SWEPT ELBOW SAE FLANGE 6000 PSI

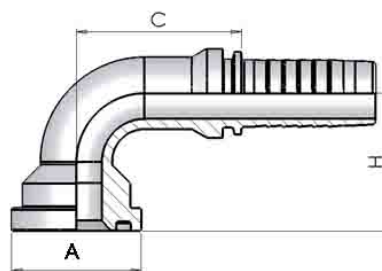

Part Number	Nominal SAE Flange size (A)	Hose I.D (Inches)	Hose I.D (mm)	Dash size	Flange OD mm (T)	Drop - H	Cutoff - C
S61-0808	1/2	1/2	12.7	08	31.7	39	39
S61-1208	3/4	1/2	12.7	08	41.3	48	39
S61-1212	3/4	3/4	19	12	41.3	55	56
S61-1612	1	3/4	19	12	47.6	63	56
S61-1616	1	1	25.4	16	47.6	69	70
S61-2016	1.1/4	1	25.4	16	54	74	71
S61-2020	1.1/4	1.1/4	31.8	20	54	83	87
S61-2420	1.1/2	1.1/4	31.8	20	63.5	90	87
S61-2424	1.1/2	1.1/2	38.1	24	63.5	99	102
S61-3224	2	1.1/2	38.1	24	79.4	108	103
S61-3232	2	2	50.8	32	79.4	136	125

† - Please contact Hydraulink for further details and availability.

Pricing current as at 14 Feb 2017 and excludes GST. Hydraulink reserve the right to change pricing and technical specifications without notice.