

PEAL® Black & Galvanised Mild Steel Male-Female Elbow

| Black & Galvanised Mild Steel Male-Female Elbow | | | | | |
|---|------------|---------------|-----|-----|----------------|
| AAP CODE | | IMPERIAL SIZE | A | C | APPROX (KG/PC) |
| BLACK | GALVANISED | | | | |
| SEMF08 | SEMF08G | 1/4 | 40 | 19 | 0.05 |
| SEMF10 | SEMF10G | 3/8 | 44 | 22 | 0.07 |
| SEMF15 | SEMF15G | 1/2 | 58 | 28 | 0.17 |
| SEMF20 | SEMF20G | 3/4 | 67 | 34 | 0.22 |
| SEMF25 | SEMF25G | 1 | 70 | 43 | 0.35 |
| SEMF32 | SEMF32G | 1 1/4 | 90 | 50 | 0.61 |
| SEMF40 | SEMF40G | 1 1/2 | 97 | 57 | 0.82 |
| SEMF50 | SEMF50G | 2 | 115 | 70 | 1.15 |
| SEMF65 | SEMF65G | 2 1/2 | 150 | 89 | 2.09 |
| SEMF80 | SEMF80G | 3 | 160 | 98 | 2.48 |
| SEMF94 | SEMF94G | 4 | 187 | 126 | 4.45 |

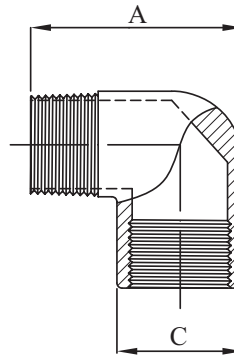

PEAL® Black & Galvanised Mild Steel Hexagon Nipple (Equal)

| Black & Galvanised Mild Steel Hexagon Nipple (Equal) | | | | | |
|--|------------|---------------|-----|--------------|-----------------|
| AAP CODE | | IMPERIAL SIZE | A | ACROSS FLATS | APPROX. (KG/PC) |
| BLACK | GALVANISED | | | B | |
| SN06 | SN06G | 1/8 | 27 | 11 | 0.01 |
| SN08 | SN08G | 1/4 | 33 | 16 | 0.03 |
| SN10 | SN10G | 3/8 | 34 | 19 | 0.04 |
| SN15 | SN15G | 1/2 | 46 | 22 | 0.07 |
| SN20 | SN20G | 3/4 | 47 | 27 | 0.08 |
| SN25 | SN25G | 1 | 52 | 35 | 0.13 |
| SN32 | SN32G | 1 1/4 | 61 | 47 | 0.27 |
| SN40 | SN40G | 1 1/2 | 61 | 52 | 0.31 |
| SN50 | SN50G | 2 | 68 | 61 | 0.48 |
| SN65 | SN65G | 2 1/2 | 79 | 79 | 0.77 |
| SN80 | SN80G | 3 | 88 | 92 | 1.35 |
| SN94 | SN94G | 4 | 101 | 117 | 2.32 |

