

PEAL® Black & Galvanised Mild Steel Hexagon Reducing Nipple

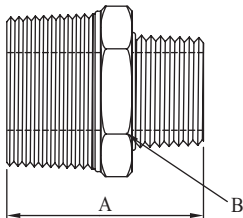

Black & Galvanised Mild Steel Hexagon Reducing Nipple					
AAP CODE		IMPERIAL SIZE	A	ACROSS FLATS	APPROX. (KG/PC)
BLACK	GALVANISED			B	
SN0806	SN0806G	1/4 X 1/8	30	16	0.02
SN1006	SN1006G	3/8 X 1/8	31	19	0.03
SN1008	SN1008G	3/8 X 1/4	34	19	0.04
SN1508	SN1508G	1/2 X 1/4	40	22	0.05
SN1510	SN1510G	1/2 X 3/8	40	22	0.06
SN2010	SN2010G	3/4 X 3/8	42	27	0.07
SN2015	SN2015G	3/4 X 1/2	47	27	0.09
SN2515	SN2515G	1 X 1/2	50	35	0.13
SN2520	SN2520G	1 X 3/4	50	35	0.13
SN3220	SN3220G	1 1/4 X 3/4	55	47	0.25
SN3225	SN3225G	1 1/4 X 1	57	47	0.24
SN4020	SN4020G	1 1/2 X 3/4	57	52	0.32
SN4025	SN4025G	1 1/2 X 1	59	52	0.30
SN4032	SN4032G	1 1/2 X 1 1/4	63	52	0.34
SN5020	SN5020G	2 X 3/4	60	61	0.41
SN5025	SN5025G	2 X 1	62	61	0.52
SN5032	SN5032G	2 X 1 1/4	66	61	0.51
SN5040	SN5040G	2 X 1 1/2	66	61	0.49
SN6540	SN6540G	2 1/2 X 1 1/2	73	79	0.87
SN6550	SN6550G	2 1/2 X 2	74	79	0.75
SN8050	SN8050G	3 X 2	81	92	1.25
SN8065	SN8065G	3 X 2 1/2	85	92	1.15
SN9450	SN9450G	4 X 2	88	115	2.20
SN9480	SN9480G	4 X 3	96	115	2.34

PEAL® Black & Galvanised Mild Steel Socket (Type Heavy)

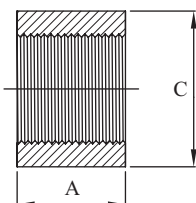
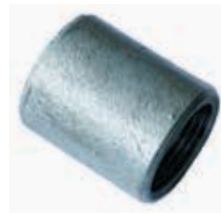

Black & Galvanised Mild Steel Socket (Type Heavy)					
AAP CODE		IMPERIAL SIZE	A	C	APPROX. (KG/PC)
BLACK	GALVANISED				
SS06	SS06G	1/8	19.3	15.6	0.01
SS08	SS08G	1/4	27.0	18.5	0.03
SS10	SS10G	3/8	28.0	22.0	0.04
SS15	SS15G	1/2	37.0	27.0	0.07
SS20	SS20G	3/4	39.0	32.5	0.09
SS25	SS25G	1	46.0	39.5	0.15
SS32	SS32G	1 1/4	51.0	49.0	0.22
SS40	SS40G	1 1/2	51.0	56.0	0.29
SS50	SS50G	2	60.0	68.0	0.44
SS65	SS65G	2 1/2	69.0	84.0	0.67
SS80	SS80G	3	75.0	98.0	0.96
SS94	SS94G	4	87.0	124.0	1.55
SS95	SS95G	5	96.0	151.0	2.37
SS96	SS96G	6	96.0	178.0	3.03