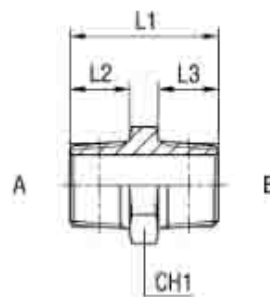

**STRAIGHT ADAPTORS**
**A-A**
**MALE BSPT X BSPT STRAIGHT  
 BSPT MALE X MALE WITH 60° CONE**

Part Number	BSPT Male Thread (A)	BSPT Male Thread (B)	Overall Length mm (L1)	Thread Length - mm (L2)	Thread Length - mm (L3)	Hex A/F (CH1)
A-A-0202	1/8-28	1/8-28	26	10	10	12
A-A-0204	1/8-28	1/4-19	30.5	10	14.5	14
A-A-0404	1/4-19	1/4-19	34	14.5	14.5	14
A-A-0406	1/4-19	3/8-19	35	14.5	15	17
A-A-0408	1/4-19	1/2-14	43	15	20	22
A-A-0412	1/4-19	3/4-14	45	15	20	27
A-A-0606	3/8-19	3/8-19	36	15	15	17
A-A-0608	3/8-19	1/2-14	43	15	20	22
A-A-0612	3/8-19	3/4-14	45	15	20	27
A-A-0616	3/8-19	1-11	51.5	15	25.5	36
A-A-0808	1/2-14	1/2-14	44.7	18.5	18.5	22
A-A-0812	1/2-14	3/4-14	48	20	20	27
A-A-0816	1/2-14	1-11	56.5	20	25.5	36
A-A-1010	5/8-14	5/8-14	46.7	19	19	24
A-A-1212	3/4-14	3/4-14	48	20	20	27
A-A-1216	3/4-14	1-11	55.5	20	25.5	36
A-A-1220	3/4-14	1.1/4-11	58.5	20	26.5	46
A-A-1616	1-11	1-11	61	25.5	25.5	36
A-A-1620	1-11	1.1/4-11	64.5	25.5	26.5	46
A-A-1624	1-11	1.1/2-11	66	25.5	26.5	50
A-A-2020	1.1/4-11	1.1/4-11	65.5	26.5	26.5	46
A-A-2024	1.1/4-11	1.1/2-11	67	26.5	26.5	50
A-A-2424	1.1/2-11	1.1/2-11	67	26.5	26.5	50
A-A-2432	1.1/2-11	2-11	71.5	26.5	30	65
A-A-3232	2-11	2-11	75	30	30	65