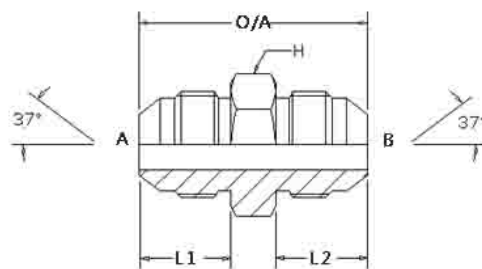

STRAIGHT ADAPTORS
G-G

 MALE JIC X JIC STRAIGHT
 JIC MALE X MALE WITH 37° CONE

Part Number	JIC Male Thread (A)	JIC Male Thread (A)	L1 - mm	L2 - mm	overall length	Hex A/F (CH1)
G-G-0707	7/16-20	7/16-20	14	14	34.8	12.7
G-G-0709	7/16-20	7/16-20	14	14.2	35.6	15.9
G-G-0808	1/2-20	1/2-20	14	14	34.8	14.3
G-G-0909	9/16-18	9/16-18	14.2	14.2	35.8	15.9
G-G-0912	9/16-18	9/16-18	14.2	16.7	38.6	20.6
G-G-1212	3/4-16	3/4-16	16.7	16.7	41.1	20.6
G-G-1214	3/4-16	3/4-16	16.7	19.3	45.2	23.8
G-G-1217	3/4-16	3/4-16	16.7	21.9	49.5	28.6
G-G-1414	7/8-14	7/8-14	19.3	19.3	47.8	23.8
G-G-1417	7/8-14	7/8-14	19.3	21.9	52.1	28.6
G-G-1717	1.1/16-12	1.1/16-12	21.9	21.9	54.9	28.6
G-G-1719	1.1/16-12	1.1/16-12	21.9	22.8	55.4	31.8
G-G-1721	1.1/16-12	1.1/16-12	21.9	23.1	55.9	34.9
G-G-1919	1.3/16-12	1.3/16-12	22.8	22.8	56.1	31.8
G-G-2121	1.5/16-12	1.5/16-12	23.1	23.1	57.2	34.9
G-G-2126	1.5/16-12	1.5/16-12	23.1	24.2	60.5	42.9
G-G-2626	1.5/8-12	1.5/8-12	24.2	24.2	61.7	42.9
G-G-3030	1.7/8-12	1.7/8-12	27.5	27.5	69.9	50.8
G-G-4040	2.1/2-12	2.1/2-12	33.9	33.9	86.4	66.7

† - Please contact Hydraulink for further details and availability.

Pricing current as at 14 Feb 2017 and excludes GST. Hydraulink reserve the right to change pricing and technical specifications without notice.