

Galvanised Malleable Male-Female Elbow 90 Degree

| Galvanised Malleable Male-Female Elbow 90 Degree | | | | |
|--|---------------|------|-------|--------------|
| AAP CODE | IMPERIAL SIZE | A | B | APPROX KG/PC |
| LEMF08 | 1/4 | 20.2 | 29.6 | 0.05 |
| LEMF10 | 3/8 | 24.1 | 37.6 | 0.07 |
| LEMF15 | 1/2 | 27.9 | 40.4 | 0.10 |
| LEMF20 | 3/4 | 32.6 | 47.0 | 0.18 |
| LEMF25 | 1 | 37.3 | 53.3 | 0.27 |
| LEMF32 | 1-1/4 | 44.5 | 65.2 | 0.43 |
| LEMF40 | 1-1/2 | 48.3 | 66.9 | 0.62 |
| LEMF50 | 2 | 56.1 | 81.1 | 1.02 |
| LEMF65 | 2-1/2 | 67.2 | 96.0 | 1.51 |
| LEMF80 | 3 | 76.6 | 112.3 | 2.39 |
| LEMF94 | 4 | 94.4 | 141.6 | 4.06 |

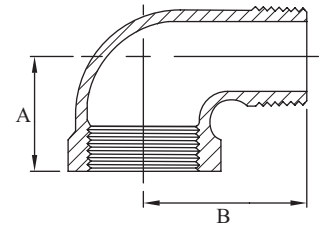

Galvanised Malleable Male-Female Elbow 45 Degree

| Galvanised Malleable Male-Female Elbow 45 Degree | | | | |
|--|---------------|------|------|--------------|
| AAP CODE | IMPERIAL SIZE | A | B | APPROX KG/PC |
| LEMFF15 | 1/2 | 21.9 | 33.0 | 0.09 |
| LEMFF20 | 3/4 | 24.4 | 37.5 | 0.13 |
| LEMFF25 | 1 | 27.9 | 43.0 | 0.22 |
| LEMFF32 | 1-1/4 | 32.1 | 47.4 | 0.32 |
| LEMFF40 | 1-1/2 | 35.6 | 52.0 | 0.46 |
| LEMFF50 | 2 | 41.8 | 60.4 | 0.76 |

