

Stainless Steel Ball Valve (1 PCE) - Maxiflo

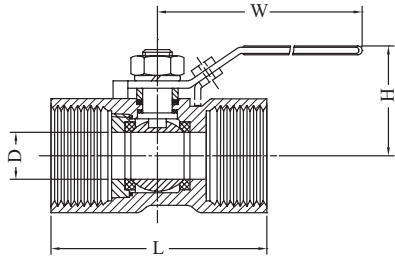

| MATERIAL LIST | |
|---------------|---|
| PART | MATERIAL |
| Body | CF8M |
| Ball | 316 Stainless Steel |
| Seat | Teflon (PTFE) |
| Stem | 316 Stainless Steel |
| Lever | 316 Stainless Steel with Locking Device |

| SPECIFICATIONS | |
|-------------------------|----------|
| Thread | AS1722.1 |
| Max Working Temperature | 180°C |
| Cold Working Pressure | 6895kPa |

Applications - For air, water, Hot/Cold corrosive fluids in harsh environments

| Stainless Steel Ball Valve (1 PCE Reducing Bore) | | | | | | | |
|--|---------------|------|----|-----|------|-----------------|---------------|
| AAP CODE | IMPERIAL SIZE | L | H | W | D | TORQUE INCH/LBS | APPROX. KG/PC |
| SS1BV08 | 1/4 | 40 | 33 | 67 | 5 | 12 | 0.06 |
| SS1BV10 | 3/8 | 45 | 36 | 67 | 7 | 12 | 0.1 |
| SS1BV15 | 1/2 | 58 | 37 | 93 | 9 | 12 | 0.16 |
| SS1BV20 | 3/4 | 60 | 42 | 93 | 12.5 | 18 | 0.26 |
| SS1BV25 | 1 | 71 | 52 | 103 | 16 | 36 | 0.38 |
| SS1BV32 | 1 1/4 | 78 | 56 | 103 | 20 | 54 | 0.61 |
| SS1BV40 | 1 1/2 | 82.5 | 65 | 125 | 25 | 72 | 0.85 |
| SS1BV50 | 2 | 100 | 70 | 125 | 32 | 84 | 1.4 |

Stainless Steel Ball Valve (2 PCE) - Maxiflo

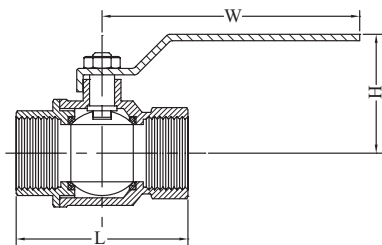

| MATERIAL LIST | |
|---------------|---|
| PART | MATERIAL |
| Body | CF8M |
| Ball | 316 Stainless Steel |
| Seat | Teflon (PTFE) |
| Stem | 316 Stainless Steel |
| Lever | 316 Stainless Steel with Locking Device |

| SPECIFICATIONS | |
|-------------------------|----------|
| Thread | AS1722.1 |
| Max Working Temperature | 180°C |
| Cold Working Pressure | 6895kPa |

Applications - For air, water, Hot/Cold corrosive fluids in harsh environments

| Stainless Steel Ball Valve (2 PCE Full Bore) | | | | | | | |
|--|---------------|------|-----|-----|-----------------|---------------|--|
| AAP CODE | IMPERIAL SIZE | L | H | W | TORQUE INCH/LBS | APPROX. KG/PC | |
| SS2BV08 | 1/4 | 48 | 48 | 100 | 36 | 0.18 | |
| SS2BV10 | 3/8 | 48 | 48 | 100 | 36 | 0.19 | |
| SS2BV15 | 1/2 | 58 | 52 | 100 | 43 | 0.26 | |
| SS2BV20 | 3/4 | 65.7 | 61 | 127 | 65 | 0.4 | |
| SS2BV25 | 1 | 77 | 65 | 127 | 101 | 0.59 | |
| SS2BV32 | 1 1/4 | 90 | 79 | 154 | 158 | 1 | |
| SS2BV40 | 1 1/2 | 98 | 83 | 154 | 187 | 1.32 | |
| SS2BV50 | 2 | 121 | 97 | 192 | 230 | 2.46 | |
| SS2BV65 | 2 1/2 | 145 | 135 | 244 | 430 | 4.83 | |
| SS2BV80 | 3 | 166 | 144 | 244 | 1380 | 7.45 | |