

## 90 DEGREE ADAPTORS

### G-GK-90

MALE JIC 90° BULKHEAD

JIC MALE X MALE 90° BULKHEAD FORGING WITH 37° CONE

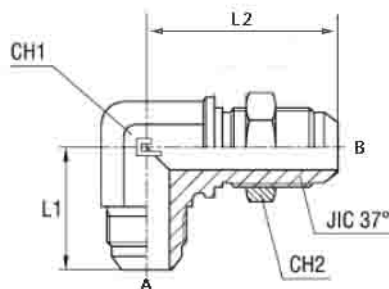

Part Number	JIC Male Thread (A)	JIC Male Thread (B)	L1 - mm	L2 - mm	Hex A/F (CH1)	Hex A/F (CH2)
G-GK-90-0707	7/16-20	7/16-20	24.6	40.4	11.1	17.5
G-GK-90-0808	1/2-20	1/2-20	26.9	43.7	14.3	19.1
G-GK-90-0909	9/16-18	9/16-18	27.7	46	14.3	20.6
G-GK-90-1212	3/4-16	3/4-16	34.5	53.6	19.1	25.4
G-GK-90-1414	7/8-14	7/8-14	39.6	60.7	22.2	28.6
G-GK-90-1717	1.1/16-12	1.1/16-12	45.2	67.8	27	34.9
G-GK-90-2121	1.5/16-12	1.5/16-12	49.3	71.1	33.3	41.3
G-GK-90-2626	1.5/8-12	1.5/8-12	55.1	79.2	41.3	47.6

† - Please contact Hydraulink for further details and availability.

Pricing current as at 14 Feb 2017 and excludes GST. Hydraulink reserve the right to change pricing and technical specifications without notice.