

General Purpose Brass Ball Valve - Maxiflo

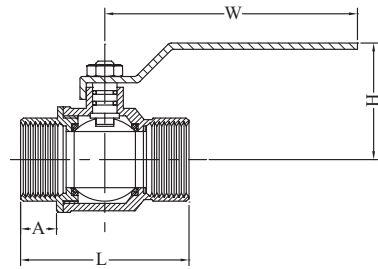

Material List	
PART	MATERIAL
Body	Brass (Nickel Plated)
Seat Retainer	Brass (Nickel Plated)
Seat	P.T.F.E.
Ball	Brass (Chromium plated)
Stem	Brass
Gland	Brass
Packing	Viton (Double O-Ring)
Lever	Stainless Steel (Plastic Coated)
Lever Retaining Nut	Brass (Nickel Plated)

Specifications	
Thread	AS1722.2
Max Working Temperature	150°C
Cold Working Pressure	2500kPa

Applications - Ideal for hot and cold water (Non-Potable), various oils, chemicals and compressed air

General Purpose Ball Valve						
AAP CODE	IMPERIAL SIZE	L	H	W	A	APPROX. KG/PC
VBB08	1/4	49.5	35	85	12	0.16
VBB10	3/8	49.5	35	85	16	0.14
VBB15	1/2	60	39	95	16.5	0.2
VBB20	3/4	66.5	43	115	18	0.3
VBB25	1	76	59.5	115	19.5	0.43
VBB32	1 1/4	92.8	63	125	23	0.74
VBB40	1 1/2	100.5	77	180	23	1.1
VBB50	2	122	89	180	27	1.72
VBB65	2 1/2	151	112	257	30	3.48
VBB80	3	174	120	301	37	5.02
VBB94	4	212	144	340	40	8.4

General Purpose M/F Brass Ball Valve

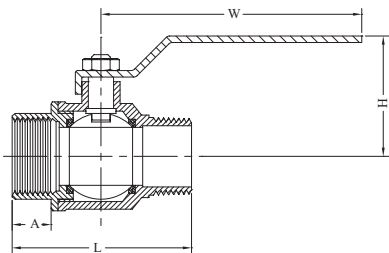

General Purpose M/F Ball Valve						
AAP CODE	IMPERIAL SIZE	L	H	W	A	APPROX. KG/PC
VBBMF08	1/4	49.5	35	85	12	0.16
VBBMF10	3/8	49.5	35	85	16	0.14
VBBMF15	1/2	60	39	95	16.5	0.2
VBBMF20	3/4	66.5	43	115	18	0.3
VBBMF25	1	76	59.5	115	19.5	0.43
VBBMF32	1 1/4	92.8	63	125	23	0.74
VBBMF40	1 1/2	100.5	77	180	23	1.1
VBBMF50	2	122	89	180	27	1.72